

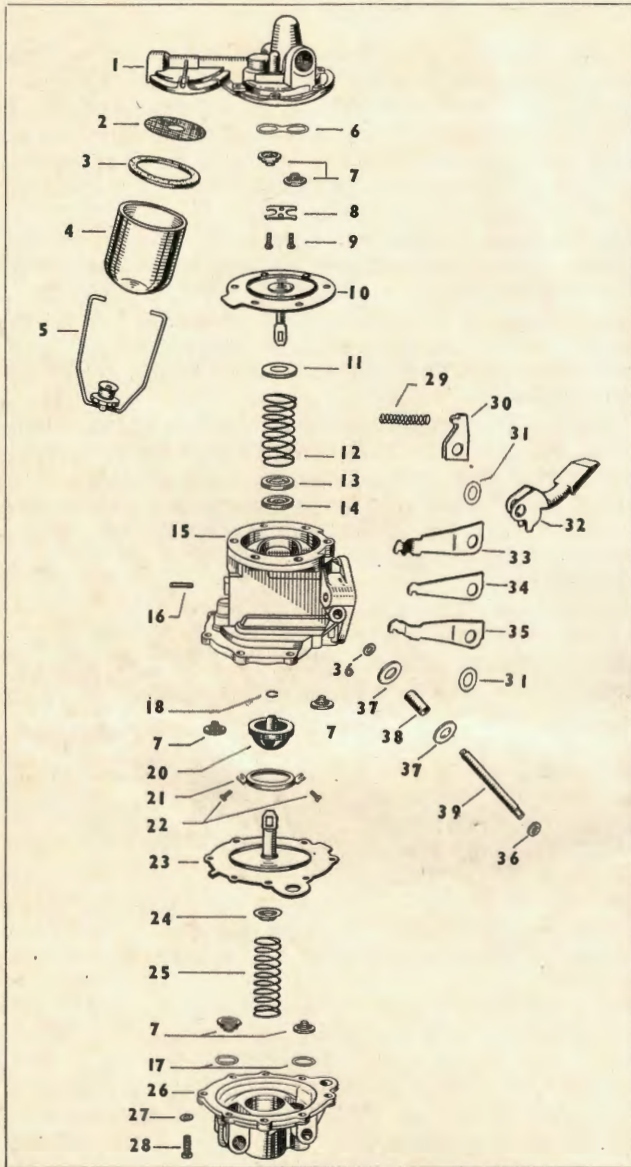

# FUEL/VACUUM PUMPS REPAIR INSTRUCTIONS



## KEY TO PART NAMES

Illus. No.	Description	Illus. No.	Description
1	Upper Casting	22	Oil Seal Screw vacuum
2	Filter Gauze .. fuel	23	Diaphragm Assembly vacuum
3	Filter Bowl Gasket .. fuel	24	Spring Seat .. vacuum
4	Filter Bowl .. fuel	25	Spring Diaphragm vacuum
5	Filter Bowl Retainer fuel	26	Lower Casting vacuum
6	Valve Gasket .. fuel	27	Lock Washer
7	Valve Assembly fuel and vacuum	28	Screw Diaphragm Clamping
8	Valve Retainer .. fuel	29	Rocker Arm Spring
9	Valve Retaining Screw fuel	30	Link Spacer
10	Diaphragm Assembly fuel	31	Rocker Pin Shim Washer
11	Spring Locator .. fuel	32	Rocker Arm
12	Spring-Diaphragm .. fuel	33	Link R/H .. vacuum
13	Oil Seal Retainer .. fuel	34	Link Centre .. fuel
14	Oil Seal .. fuel	35	Link L/H .. vacuum
15	Body	36	Rocker Pin Retaining Washer
16	Breather Pipe	37	Rocker Pin Spacing Washer
17	Valve Gasket vacuum	38	Rocker Pin Bush
18	Oil Seal Retaining Circlip	39	Rocker Arm Pin
19			
20	Oil Seal .. vacuum		
21	Oil Seal Retainer vacuum		

## REPLACING VACUUM OIL SEALS (A) EARLY TYPE

The oil seal on the vacuum side, which is readily accessible, can be prised out of the pump body with any suitable tool, such as a large screwdriver.

As the oil seal on the fuel side is deeply recessed, this should be driven out from the other side of the body, after removal of the vacuum oil seal, as already described.

The method for fitting new seals is shown below, and a flat-ended punch,  $\frac{1}{8}$ " diameter, must be used to lightly drive home the steel retainer of the replacement seal. Afterwards the surrounding portion of the pump body should be lightly staked to prevent any possibility of the oil seal working out of position.

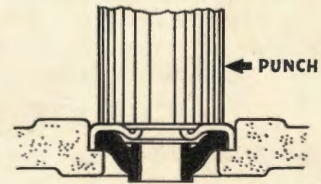

## (B) LATEST TYPE (Below)

Before being fitted to the pump, the diaphragm assembly must have fitted to it the three oil seal parts shown in the following illustration. The small end of the oil seal should be located just below the flattened end of the pull rod leaving just sufficient room for the split washer to be fitted.

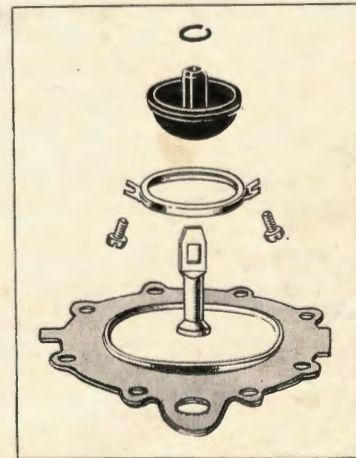

## IMPORTANT

Vacuum Section Oil Seals should be replaced every time the diaphragm assembly is renewed.

## KEY TO PUMP TYPES

### WE

Combined fuel and vacuum pump. Early type has detachable lower vacuum cover.

Later double acting type has one-piece lower casting.

**WG** As WE but filter bowl on top.

**WH** As WE but no filter.

**W** Vacuum pump only.